

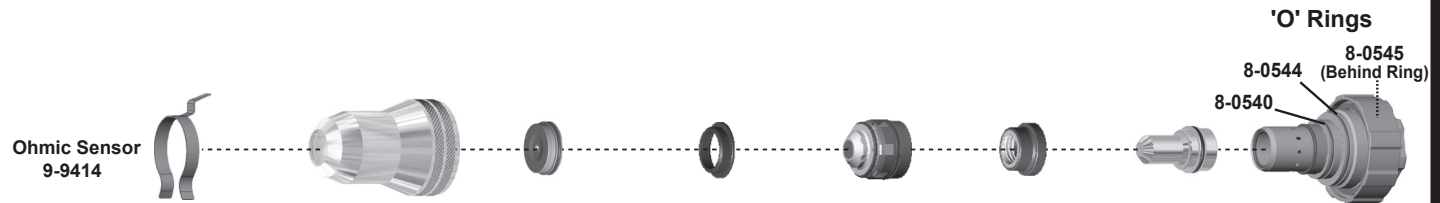

THERMAL DYNAMICS
www.thermal-dynamics.com

XT-301™ Conventional Plasma Torch Auto-Cut™ 55-100 Amps



	Amps	Plasma/Shield Gas	Shield Cup	Shield Cap	Shield Gas Distributor	Tip	Plasma Gas Distributor	Electrode	Cartridge
Mild Steel	55A	Air Plasma / Air Shield	36-1016	36-1025	36-1272	36-1051	36-1041	36-1069	36-1020
		O2 Plasma / Air Shield	36-1016	36-1025	36-1272	36-1051	36-1041	36-1069	36-1020
	100A	Air Plasma / Air Shield	36-1016	36-1027	36-1272	36-1053	36-1041	36-1071	36-1020
		O2 Plasma / Air Shield	36-1016	36-1027	36-1272	36-1053	36-1041	36-1071	36-1020

Stainless Steel Aluminum	55A	Air Plasma / Air Shield	36-1016	36-1034	36-1272	36-1060	36-1041	36-1078	36-1020
	100A	Air Plasma / Air Shield	36-1016	36-1027	36-1272	36-1053	36-1041	36-1071	36-1020
		N2 Plasma / H2O Shield	36-1016	36-1034	36-1272	36-1053	36-1041	36-1089	36-1020
		H35 Plasma / N2 Shield	36-1016	36-1034	36-1272	36-1062	36-1041	36-1080	36-1020



THERMAL DYNAMICS
www.thermal-dynamics.com

XT-301™ Conventional Plasma Torch Auto-Cut® 200-300 Amps

Auto-Cut® 200
Auto-Cut® 300

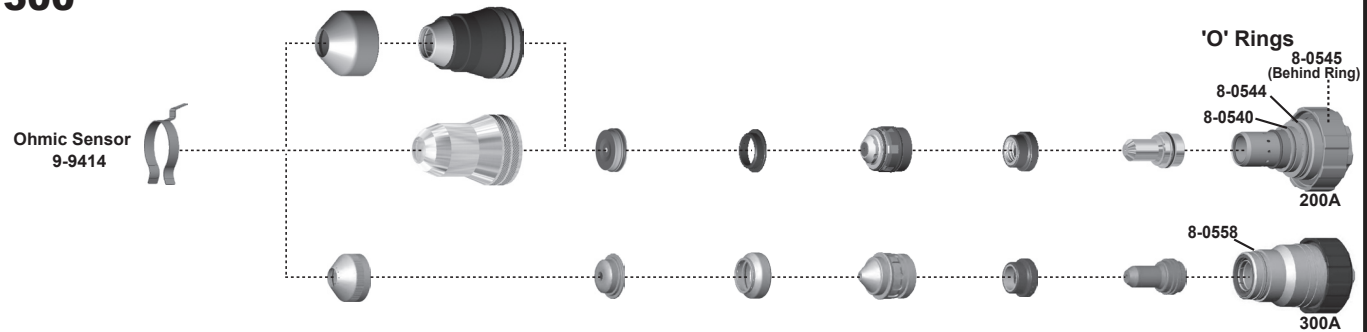

	Amps	Plasma/Shield Gas	Shield Retainer	Shield Cup	Shield Cap	Shield Gas Distributor	Tip	Plasma Gas Distributor	Electrode	Cartridge
Mild Steel	200A	Air Plasma / Air Shield	36-1019	36-1018	36-1028	36-1280	36-1055	36-1041	36-1085	36-1020
		O2 Plasma / Air Shield	36-1019	36-1018	36-1029	36-1281	36-1056	36-1041	36-1085	36-1020
	300A	Air Plasma / Air Shield	36-1021		36-1037	36-1283	36-1050	36-1044	36-1088	36-1022

Stainless Steel Aluminum	200A	Air Plasma / Air Shield	36-1019	36-1018	36-1030	36-1282	36-1055	36-1041	36-1085	36-1020
		H35 Plasma / N2 Shield		36-1016	36-1031 ($< 1"$ (25mm)) 36-1032 ($\geq 1"$ (25mm))	36-1273	36-1058	36-1043	36-1087	36-1020
		N2 Plasma / H2O Shield		36-1016	36-1039	36-1273	36-1064	36-1046	36-1089	36-1020
	300A	Air Plasma / Air Shield	36-1021		36-1037	36-1283	36-1050	36-1044	36-1088	36-1022



THERMAL DYNAMICS®
www.thermal-dynamics.com

XT-301™ Conventional Plasma Torch Auto-Cut™ 200-300 Amps

Auto-Cut™ 200 O₂
Auto-Cut™ 300 O₂

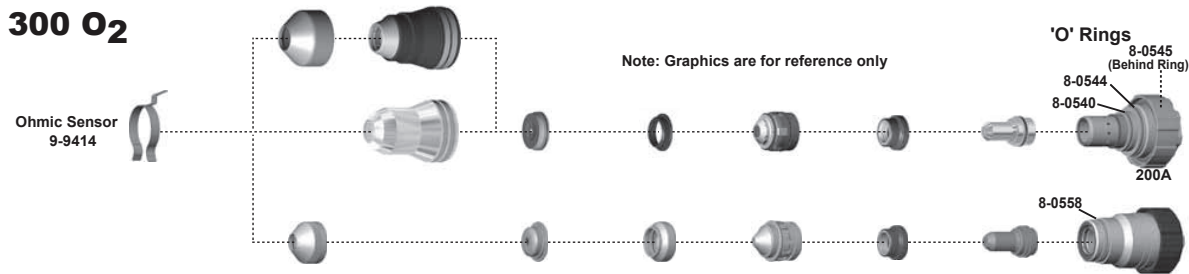

	Amps	Plasma/Shield Gas	Shield Retainer	Shield Cup	Shield Cap	Shield Gas Distributor	Tip	Plasma Gas Distributor	Electrode	Cartridge
Mild Steel	200A	Air Plasma / Air Shield	36-1019	36-1018	36-1028	36-1280	36-1055	36-1041	36-1085	36-1020
		O ₂ Plasma / Air Shield	36-1019	36-1018	36-1029	36-1281	36-1056	36-1046	36-1086	36-1020
	300A	O ₂ Plasma / Air Shield	36-1021		36-1033	36-1274 (< 1" (15mm)) 36-1283 (≥ 1" (15mm))	36-1059	36-1047	36-1090	36-1022

Stainless Steel Aluminum	200A	Air Plasma / Air Shield	36-1019	36-1018	36-1029	36-1281	36-1057	36-1046	36-1085	36-1020
		H35 Plasma / N ₂ Shield		36-1016	36-1031 (< 1" (25mm)) 36-1032 (≥ 1" (25mm))	36-1273	36-1058	36-1043	36-1087	36-1020
		N ₂ Plasma / H ₂ O Shield		36-1016	36-1039	36-1273	36-1064	36-1048	36-1089	36-1020
	300A	H35 Plasma / N ₂ Shield	36-1015		36-1035 (< 1" (25mm)) 36-1036 (≥ 1" (25mm))	36-1284	36-1061	36-1043	36-1091	36-1022
		N ₂ Plasma / H ₂ O Shield	36-1015		36-1038	36-1284	36-1063	36-1048	36-1089	36-1022